

ROLLSPIN

RSP

MSF

MASS

SURFACE FINISHING

OUR EXPERIENCE, YOUR RESULTS

ROLL

WASCH





ROLLSPIN
RSP

4

3

ROLLSPIN
RSP-4/7
Made in Italy - by Rolltech



ROLLSPIN RSP



ROLLSPIN

RSP

DOOR ALARM

RSP

ROLLSPIN



ROLLSPIN
RSP-4/30 TCS
ROLL
WASCH

ROLLSPIN
RSP



RSP ROLLSPIN



Rollspin: centrifugal barreling machines

RSP-4/7-SE-STD

The “STD” version has a control board equipped with PLC, inverter and digital control.

Standard SE barrel

The “SE” barrel model is practical and quick to use, especially with two sets of 4 barrels (optional). In this case the machine can stop only for few minutes or for the required time to replace the barrels from their housing, then starts immediately with a new surface finishing process.

Outside the machine it is possible to carry out the loading and unloading of the barrel in due time, without affecting the machine productivity.

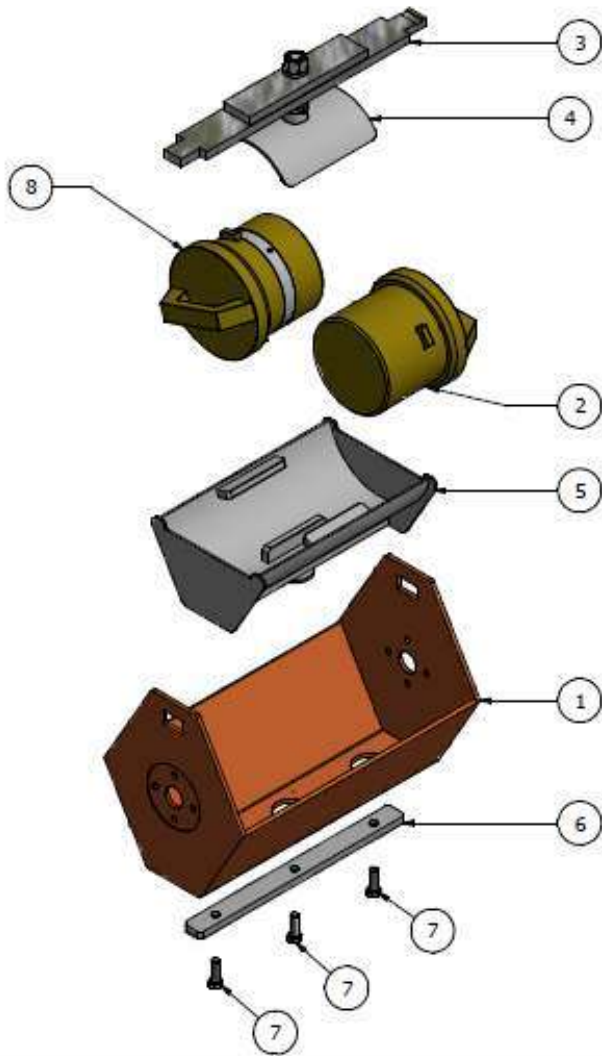
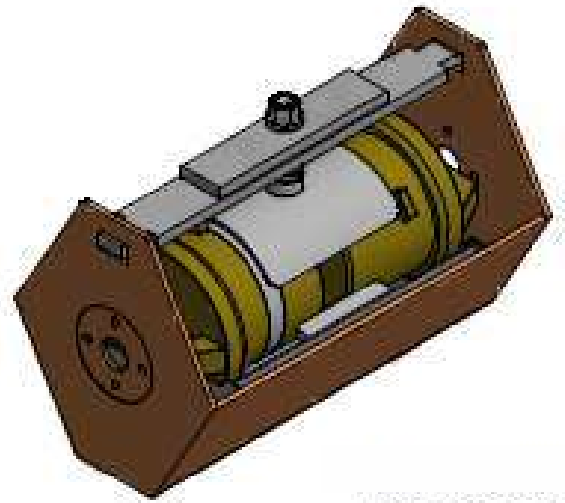

KIT-BAR-SAT-4/7-K2

Composition of the KIT Bar-Sat-4/7-K2

- 1) Existing cot of the machine type RSP-4/7-SE-STD (o-TCS)
- 2) The cot can lodge 2 barrels of 1 liter, type BAR-SAT-4/1
- 3-4) Bar complete with fixing curve-frame
- 5-6-7) Shaped cot, to be fixed with bar and screws to the existing cot (1), to lodge the barrels of 1 lt.

Kit Bar-Sat-4/7-K2T

As above, but in place of barrels pos. (2) there are pos. (8) 2 barrels **BAR-SAT-4/1-T**, with 1 internal splitter;

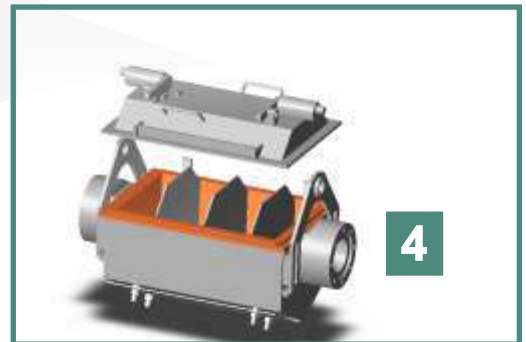
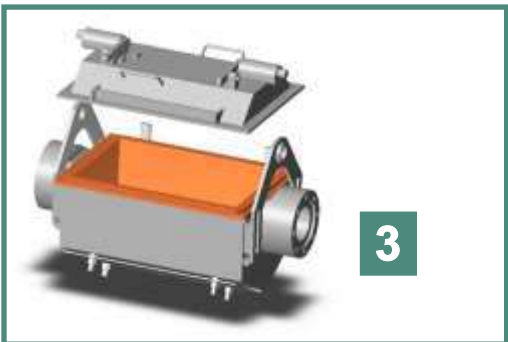

Rollspin: centrifugal barreling machines

[1] **RSP-4/30-HDS-TCS:** The Rollspin series with higher capacity follows closely both style and setting up of the smaller sized models. The Rollspin series with barrels of 30 lt capacity is not only bigger but also conceptually “different”. For example the HDS model has fixed barrels, which are not removable from the machine. This requires a second motorisation of the machine (besides the main rotation one), to help the HDS tilting each time you need to unload the content.

[2] **ELEMOVE :** These machines can be helped by a lifting unit line, if available, or as alternative, they can be equipped with optional electromechanically windlass named ELEMOVE, on demand.

[3] **Standard HDS barrel**

The “HDS” barrel version offers a high efficiency level when it is required to treat articles mounted on frames, or when with the “split-o-bar” accessory (optional) is required to divide in more working compartments the barrel and to operate single treatment of particularly delicate or precise articles.

High quality of bi-component hot-moulded polyurethane lining together with mechanical resistance assure the maximum life, compatible with the high performances of this type of machines, which sets at the top of any mass finishing or fixture technique type for high rate of speed and removal capacity at the same time.

[4] **HDS barrel with slit-o-bar accessory to divide the barrel**

The use flexibility of the RSP machines with HDS barrels is very high – it is enough to think about a machine equipped with 4 barrels having properly balanced capacity between media and articles to be treated. Each barrel is equipped with the “split-o-bar” optional accessory and with a different type of article in each compartment... .. And why not, two barrels for WET and two barrels for DRY processes....

Macchina - barili in acciaio Machine - steel barrel	N./Cap. Barile Barrel N./Cap.	Cap. Tot. Tot. Cap.	Materiale Barile Barrel material	Tipo barili Type of barrel	Tipo Consolle Comandi Control board type
RSP-4/7-SE-STD	4x7L	28L	Acciaio rivestito PU Steel - PU lining	Asportabili con coperchio laterale Removable with side cover	PLC+Inverter, tasti funzione PLC+Inverter, digital control
RSP-4/7-SE-STD-K2	8x1L	8L	PU	Asportabili con coperchio laterale Removable with side cover	PLC+Inverter, tasti funzione PLC+Inverter, digital control
RSP-4/7-SE-STD-K2T	8x1L (**)	8L	PU	Asportabili con coperchio laterale Removable with side cover	PLC+Inverter, tasti funzione PLC+Inverter, digital control
RSP-4/30-HDS-STD	4x30L	120L	Acciaio rivestito PU Steel - PU lining	Fissi - coperchio superiore (orizz.) Fixed - upper cover (horizontal)	PLC+Inverter, tasti funzione PLC+Inverter, digital control

Macchina - barili acciaio inox Machine - stainless steel barrel	N./Cap. Barile Barrel N./Cap.	Cap. Tot. Tot. Cap.	Materiale Barile Barrel material	Tipo barili Type of barrel	Tipo Consolle Comandi Control board type
RSP-4/7-SE-STD-X	4x7L	28L	Inox rivestito PU S. Steel - PU lining	Asportabili con coperchio laterale Removable with side cover	PLC+Inverter, tasti funzione PLC+Inverter, digital control

Modello barile asportabile Removable barrel model	Cap. Barile Barrel Cap.	Note: Notes:
BAR-SAT-4/7-SE	7L	Barile acciaio - coperchio laterale Steel barrel - side cover
BAR-SAT-4/7-SE-XL	7L	Barile acciaio - coperchio laterale (con spessore e rivestimento maggiorati) Steel barrel - side cover (with increased lining and thickness)
BAR-SAT-4/7-SE-INOX	7L	Barile inox - coperchio laterale Stainless steel barrel - side cover
BAR-SAT-4/7-SE-INOX-XL	7L	Barile inox - coperchio laterale (con spessore e rivestimento maggiorati) Stainless steel barrel - side cover (with increased lining and thickness)
KIT BAR-SAT-4/7-K2	4X(2x1L)	Barile in PU - coperchio laterale PU Barrel - side cover
KIT BAR-SAT-4/7-K2T	4x(2x1L) (**)	Barile in PU - coperchio laterale PU Barrel - side cover

Modello barile Fisso (*) Fixed barrel model (*)	Cap. Barile Barrel Cap.	Note: Notes:	Accessorio opz. di sollevamento (applicabile a lato): Lifting optional device (to be placed on the side):
BAR-SAT-4/30-HDS-INOX	30L	Barile acciaio inox - cop. superiore S. Steel barrel - upper cover	ELEMOVE - verricello elettr. + comando - solleva i barili ELEMOVE - elect. windlass + barrel lift control

(*) Barile fisso
(*) Fixed barrel
(**) Barile da 1L suddiviso in 2 da un separatore
(**) 1L barrel divided in 2 parts by means of a splitter

Barile SE - SE barrel



Barile K2T - K2T barrel



Barile HDS - HDS barrel

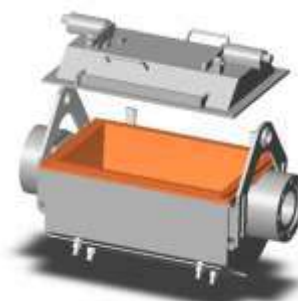

The new range

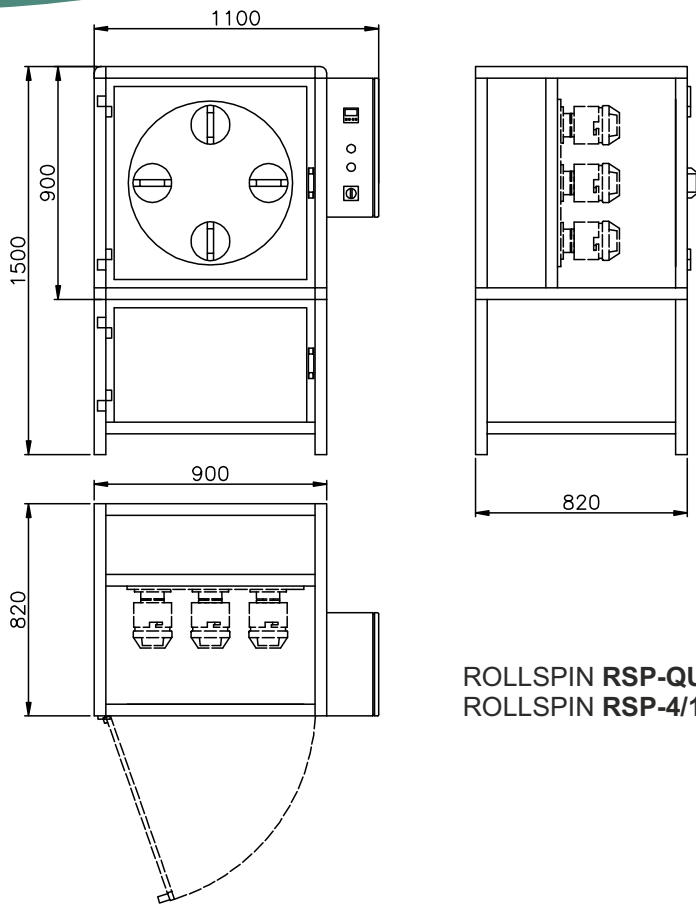

ROLLSPIN **RSP-QUATTRO** (New 2025!)
ROLLSPIN **RSP-4/1-V** (Ver. 2024)

Rollspin RSP-QUATTRO

The **RSP-4/1-V** model with 4 x 1-liter barrels, or RSP-4/4-V with 4 x 4-liter barrels, offered until 2024, are now revised and refined in a new **RSP-QUATTRO** design.

Compared to the 2024 model, the new **2025** design offers **FOUR (QUATTRO)** possible configurations, based on the same standard machine model (with identical power, control board and structure).

For example: barrel holder frames, sized for the desired capacity, can be mounted on the **RSP-QUATTRO** basic machine with three screws for support - let's see all the possible capacities:

DRY USE:

- 4 frames type: **BAR-SAT-Q-HOLD-0.3** - which can be coupled to 4 barrels type: **BAR-SAT-Q-0.3D** - or:
- 4 frames type: **BAR-SAT-Q-HOLD-1** - which can be coupled to 4 barrels type: **BAR-SAT-Q-1D** - or:
- 4 frames type: **BAR-SAT-Q-HOLD-3** - which can be coupled to 4 barrels type: **BAR-SAT-Q-3D** - or:
- 4 frames type: **BAR-SAT-Q-HOLD-4** - which can be coupled to 4 barrels type: **BAR-SAT-Q-4D**

WET USE:

- 4 frames type: **BAR-SAT-Q-HOLD-0.3** - which can be coupled to 4 barrels type: **BAR-SAT-Q-0.3W** - or:
- 4 frames type: **BAR-SAT-Q-HOLD-1** - which can be coupled to 4 barrels type: **BAR-SAT-Q-1W** - or:
- 4 frames type: **BAR-SAT-Q-HOLD-3** - which can be coupled to 4 barrels type: **BAR-SAT-Q-3W** - or:
- 4 frames type: **BAR-SAT-Q-HOLD-4** - which can be coupled to 4 barrels type: **BAR-SAT-Q-4W**

RSP-4/1-V - 2024

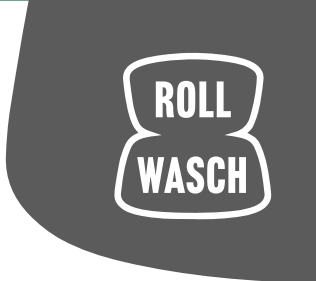

ROLLSPIN
RSP





News 2025!

RSP ROLLSPIN RSP-QUATTRO

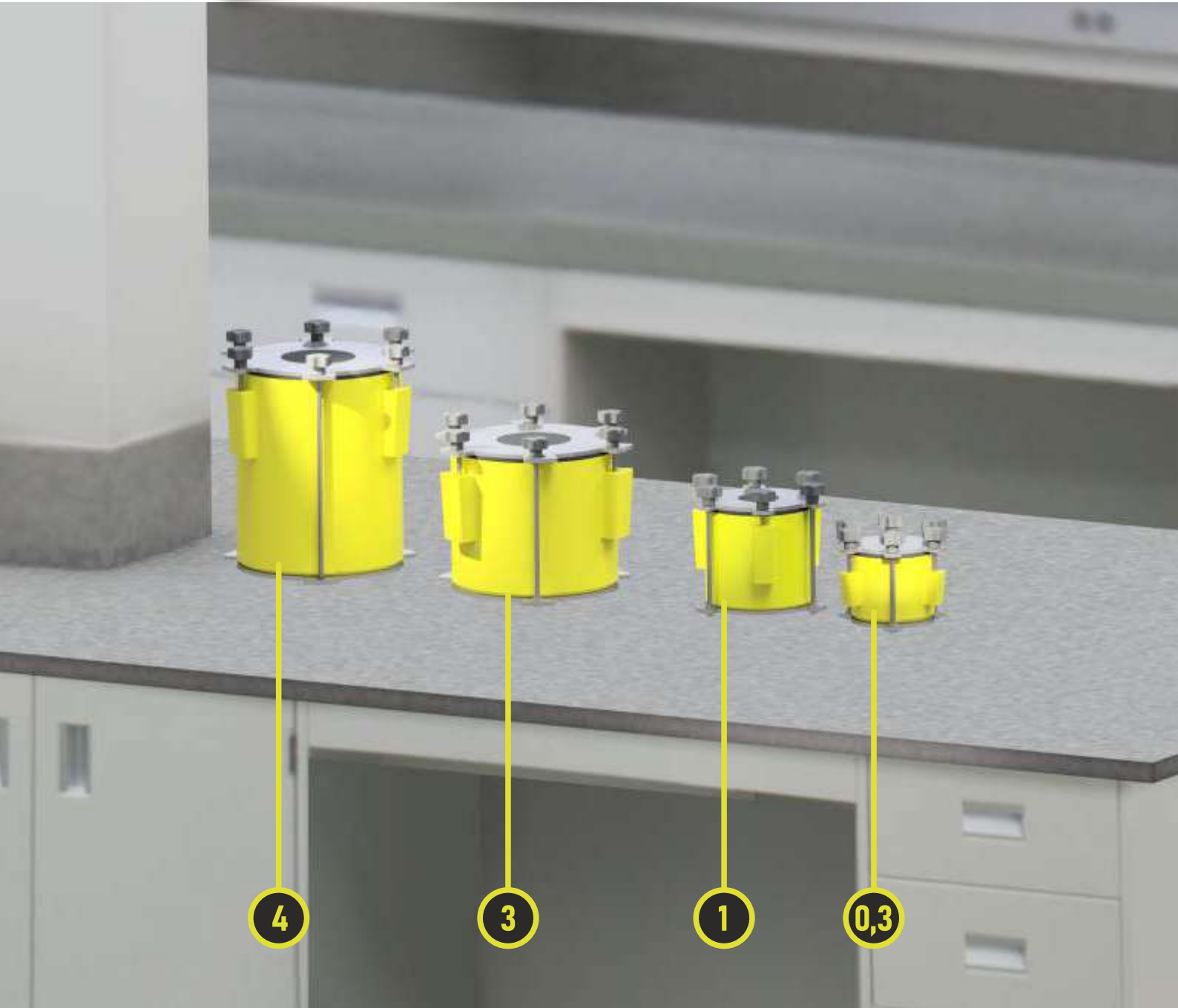

NEW DESIGN - Rollspin RSP-QUATTRO

Starting from the beginning of **2025**, on the occasion of the 75th Anniversary of the foundation of Rollwasch, the Rollspin 4/1 V model has been redesigned and optimized to be configured in three capacities with the same basic hardware.

The machine can therefore be set up with 4 barrels of 3 liters, 1 liter, or finally 0.3 liters for micro-mechanical components or very small dimensions.

RSP ROLLSPIN RSP-QUATTRO

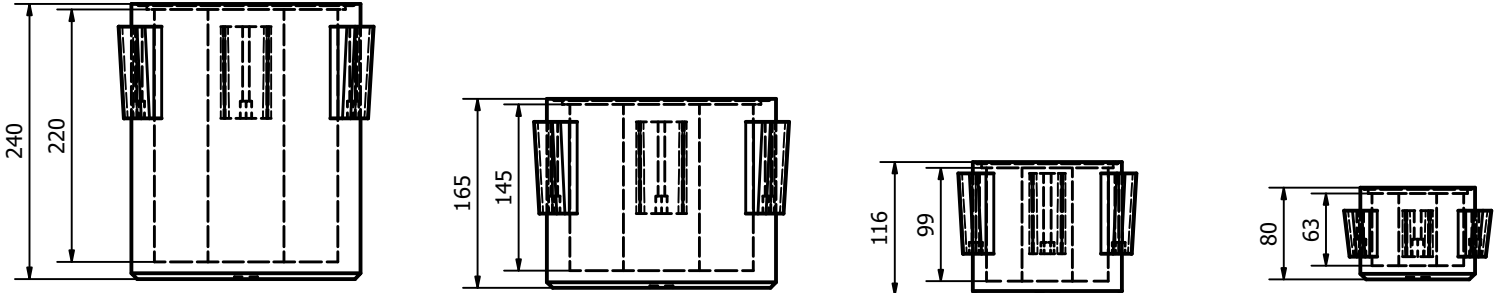

D = DRY

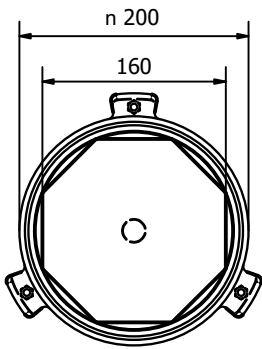

4

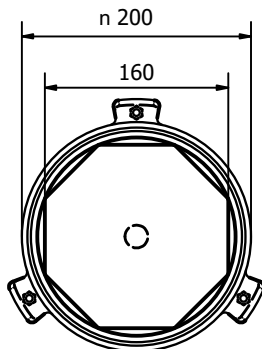

3

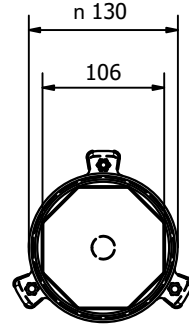

1

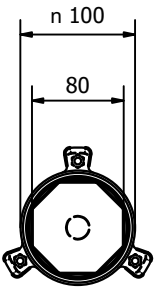

0,3

W = WET

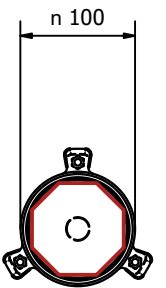
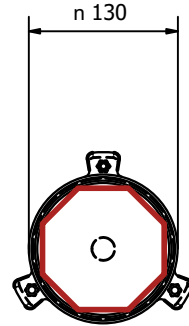
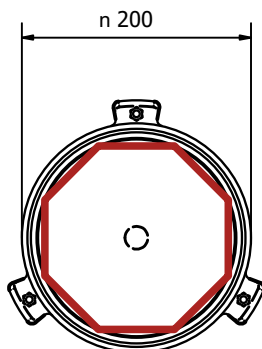
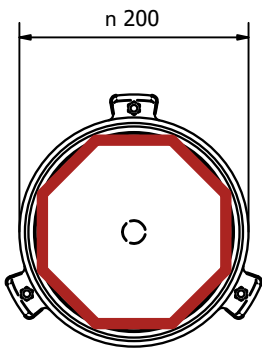

BAR SAT-Q BARRELS WITH NEW DESIGN

NEW DESIGN of the barrels in the version **WET**, **DRY** and with **FOUR** capacities, from 0.3 to 4 nominal liters.

The composition of the acronym of each type of barrel follows the rule: **BAR-SAT-Q** + Use + Capacity. The dry barrels are made in 3D printing (FDM) with composite materials with very high resistance and low weight, while the wet ones have the same external casing and, inside, an anti-abrasive coating in Polyurethane (hot cast), with variable thicknesses in relation to its capacity.



RSP ROLLSPIN RSP-QUATTRO



NEW DESIGN ALSO MEANS FREE CHOICE OF FRAME i.e.: **STANDARD** as in the version shown here, complete with compartment and door allows the storing of barrels, abrasives etc., or with final extension **SV** (Simplified, without compartment with door) or, finally: **DT** (Desk Top, table-top) - all equipped with control panel with a 4.7" touch screen panel, plc, inverter, emergency and interlock door closure;

RSP
ROLLSPIN
RSP-QUATTRO





VIA SAN CARLO, 21
20847 ALBIATE (MB) - ITALIA



TEL. +39 0362 930334
FAX. +39 0362 931440
E-MAIL INFO@ROLLWASCH.IT



WWW.ROLLWASCH.COM
PERFECT SURFACES SINCE 1950

OUR EXPERIENCE, YOUR RESULTS

